

To,
The Manager – Listing Department
BSE Limited
Phiroze Jeejeebhoy Towers,
Dalal Street,
Mumbai – 400001
Scrip Code: 544656

Subject: Disclosure under Regulation 30 of the SEBI (Listing Obligations and Disclosure Requirements) Regulations, 2015 – Submission of Investor Presentation

Dear Sir / Madam,

Pursuant to Regulation 30 read with Schedule III of the SEBI (Listing Obligations and Disclosure Requirements) Regulations, 2015, we hereby submit the Investor Presentation of HRS Aluglaze Limited ("the Company").

The Investor Presentation provides an overview of the Company's business operations, manufacturing facilities, product offerings, key projects, geographic expansion, growth strategy, management profile, and financial performance and projections, and has been prepared for the information of investors, analysts and other stakeholders.

Forward-Looking Statement Disclaimer

The Investor Presentation may contain certain forward-looking statements, including statements relating to the Company's future business outlook, growth plans, projections, expectations, assumptions, and financial estimates. These statements are based on current beliefs, assumptions, and expectations of the management and are subject to various risks, uncertainties, and other factors that could cause actual results to differ materially from those expressed or implied in such forward-looking statements.

The Company undertakes no obligation to publicly update or revise any forward-looking statements, whether as a result of new information, future events, or otherwise, except as required under applicable laws and regulations.

We request you to kindly take the above information on record.

Thanking you,
Yours faithfully,
For **HRS Aluglaze Limited**

Siddhi Mangal
Company Secretary & Compliance Officer
Membership No.: A72380



FHRSTM
ALUGLAZE LIMITED

Company Overview



➤ About HRS Aluglaze Limited



Established in 2012, **HRS Aluglaze Limited** is a Gujarat-based façade engineering and aluminium systems manufacturer company offering complete design-to-installation solutions for doors, windows, curtain walls, glazing, cladding, louvers, partitions, and UPVC systems. With fully integrated capabilities across design, engineering, fabrication, and installation.

The company operates a modern manufacturing facility at **Bavla, Ahmedabad**, spread across **11,176 sq. m.**, equipped with advanced CNC automation, in-house testing units. Its backward integration capabilities, supported by a dedicated **powder-coating unit** with a fully automated seven-tank coating system and a **422 KW rooftop solar plant** further improves cost efficiency and sustainability. To support future growth, HRS is expanding through the development of an **additional 13,714 sq. m.** of adjoining land, which will enhance production capabilities, improve execution timelines, and enable entry into new regions.



Key Facts & Figures

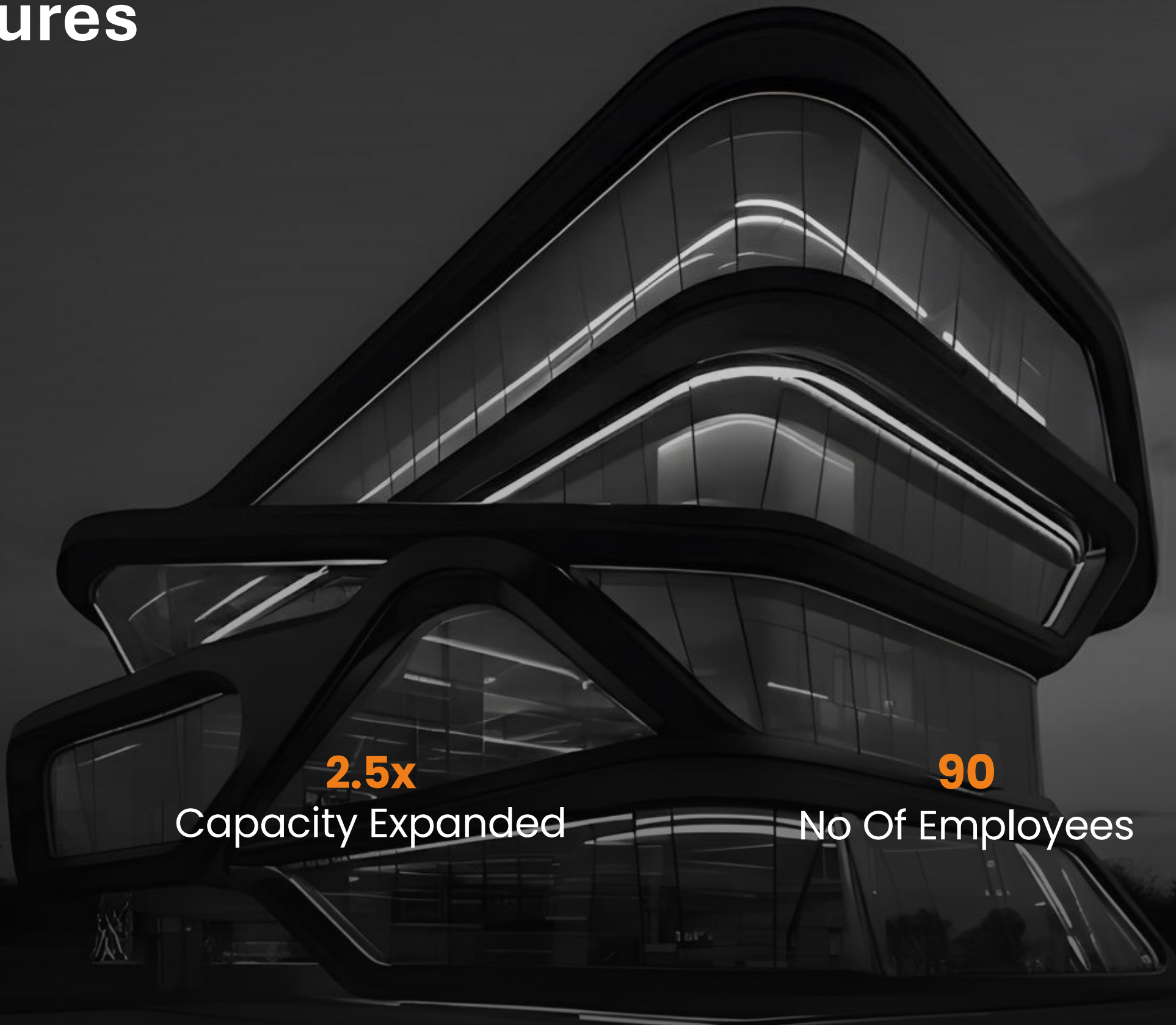

28

Active projects

34%

Utilized Capacity

**ISO 9001:2015 &
MSME ZED Bronze
Certified**

2.5x

Capacity Expanded

90

No Of Employees

35,00,000 sq. ft.

Manufacturing capacity

65.29%

Top 5 Customer
Contribution

195

Projects Completed

30

No of Machinery

Tier 1 & Tier 2 cities

Increasing presence

Major Events & Milestones

2012

Our Company was incorporated as a private limited company under the provisions of the Companies Act, 1956, under the name "HRS Aluglaze Private Limited" on March 30, 2012.

2018

Our Company purchased land for factory at Dantali, Gujarat factory.

2022

- Our Company entered market of **Hyderabad**.

2023

- Our Company entered market of **Vishakhapatnam**.

2024

- Our Company established a **uPVC (unplasticized polyvinyl chloride)** production line at its manufacturing facility. This strategic expansion enabled the Company to diversify its product offerings and cater to the growing demand in the building materials and infrastructure segments.
- Our Company commenced commercial operations at its manufacturing facility located at Rajoda, with an installed capacity of **25 Lakh Sq. Ft.** per month. The operationalisation of this plant marked a significant step in enhancing the Company's production capabilities and meeting the increasing market demand for its products.
- Our Company established a dedicated **powder coating plant** exclusively for captive consumption, to support and enhance its in-house powder coating operations. This initiative was undertaken to ensure quality control, cost efficiency, and seamless integration within the manufacturing process.
- Our Company implemented a green energy initiative by setting up a solar power plant at its newly established factory. This move aimed at promoting environmental sustainability, reducing dependency on conventional energy sources, and optimizing long-term operational efficiency through renewable energy utilization.
- Our Company was converted from a private limited company to a public limited company

2025

- Our Company entered market of **Coimbatore**.
- Our Company entered market of **Mumbai**.

➤ Competitive Strengths

- Experienced Leadership and Skilled Teams
- Proven Track Record with Strong Client Relationships
- Design, Execution, and Completions
- Commitment to Quality, Innovation, and Sustainability
- Vision to Shape the City Skyline

➤ Primary Customer Segments



Real Estate Developers

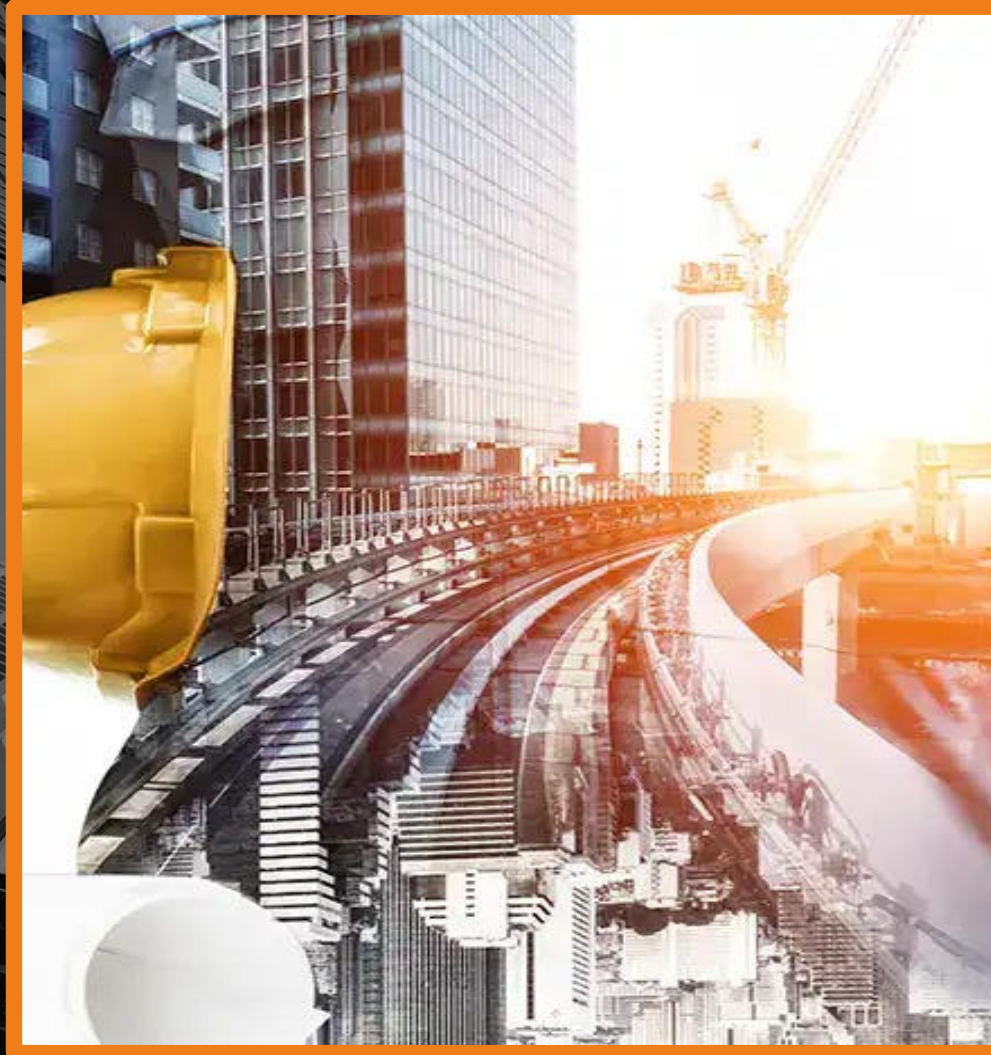

**Infrastructure &
Construction Companies**



**Hospitals, Educational &
Government Buildings**

Primary Customer Segments

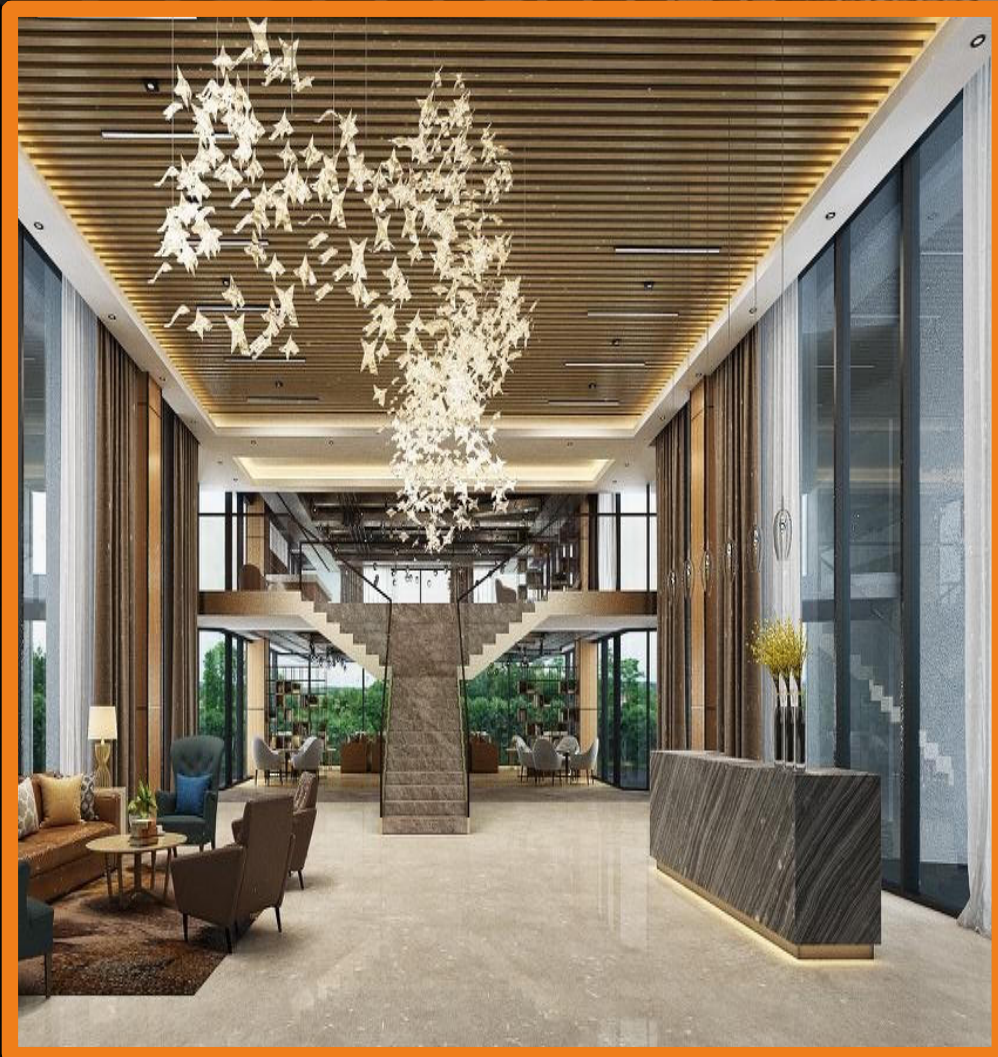

Hospitality Sector



**Individual Property Owners
& Builders**

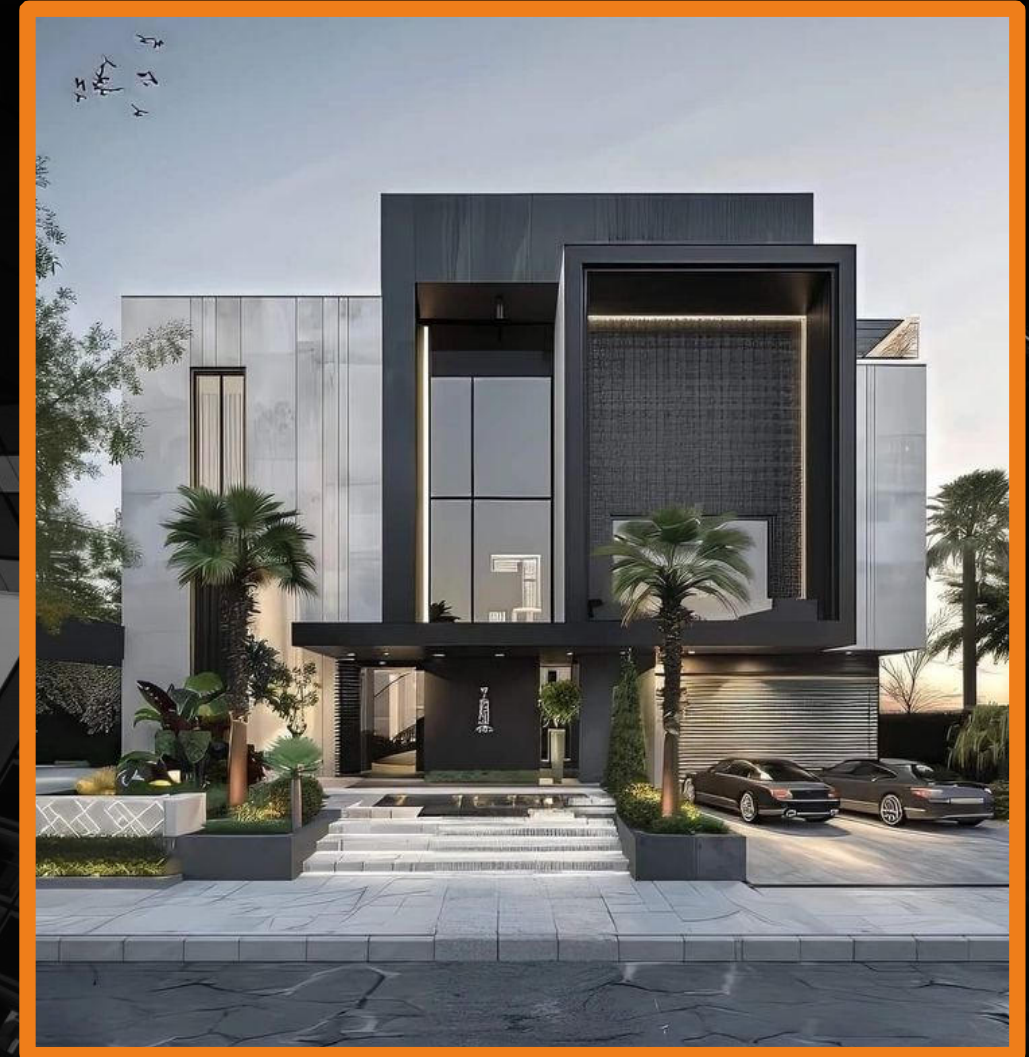

Architects & Consultants

Business Overview



Product Offerings



Doors and Windows



Curtain Walls and Structural Glazing



Glass Railings, Partitions, Louvers, and Screens



Cladding and Dynamic Facades



Material Supply and Procurement Support

Key Projects



Rajyash One

Architect : Studio Aesthetics
PMC : Team PMC
Façade Consultant : FES
Product Type : Unitised Glazing System
Total Area : 85000 sq.ft.
Start Date : June, 2025
End Date : December, 2025



Vishwanath Builders Ozone

Architect : Morpho Genesis
PMC : Masters PMC
Façade Consultant : RSM Design Solution
Product Type : Unitised Glazing System
Total Area : 70,000 sq.ft.
Start Date : December, 2025
End Date : February, 2026



Trogon Twin Towers

Architect : HM Associates
PMC : ShilpShree PMC
Façade Consultant : FES
Product Type : Unitised Glazing System
Total Area : 2,80,000 sq.ft.
Start Date : January, 2026
End Date : June, 2027

Manufacturing Facility



Bavla, Ahmedabad.

11,176 sq. mt.

Fully integrated Manufacturing facility

13,714 sq. mt.

Adjoining land added to enhance capacity and accelerate execution for regional expansion.



Solar Power Plant



422 KW rooftop
Installed a solar power plant



1 MW Solar Installation
Future capacity expansion

- Classified under **CPCB 'White Category'**, the Company operates with negligible environmental impact, ensuring clean and sustainable production practices.
- **ESG focus** is strengthened by ongoing initiatives such as **renewable energy expansion, safe working infrastructure,** quality certifications, and environmentally conscious manufacturing processes.



➤ Effluent Treatment Facility (ETP)

- Installed a **10,000 LPH effluent treatment plant** to ensure full environmental compliance.
- ETP equipped with **PSF, ACF, and 3HP OWS feed pump** for efficient treatment.
- **Smart Sub Hot Pumps** with standby + control panels ensure uninterrupted operations.
- **Grundfos Hydro Multi System** with 100L pressure tank and fixed-speed control for pressure management.
- **Grundfos CMBE Twin Pump System** ensures reliable water circulation and discharge.
- Integrated **control and automation panels** enable efficient monitoring and operations.
- ETP complies with **State Pollution Control Board norms**, ensuring treated water meets all statutory standards.

Business Process

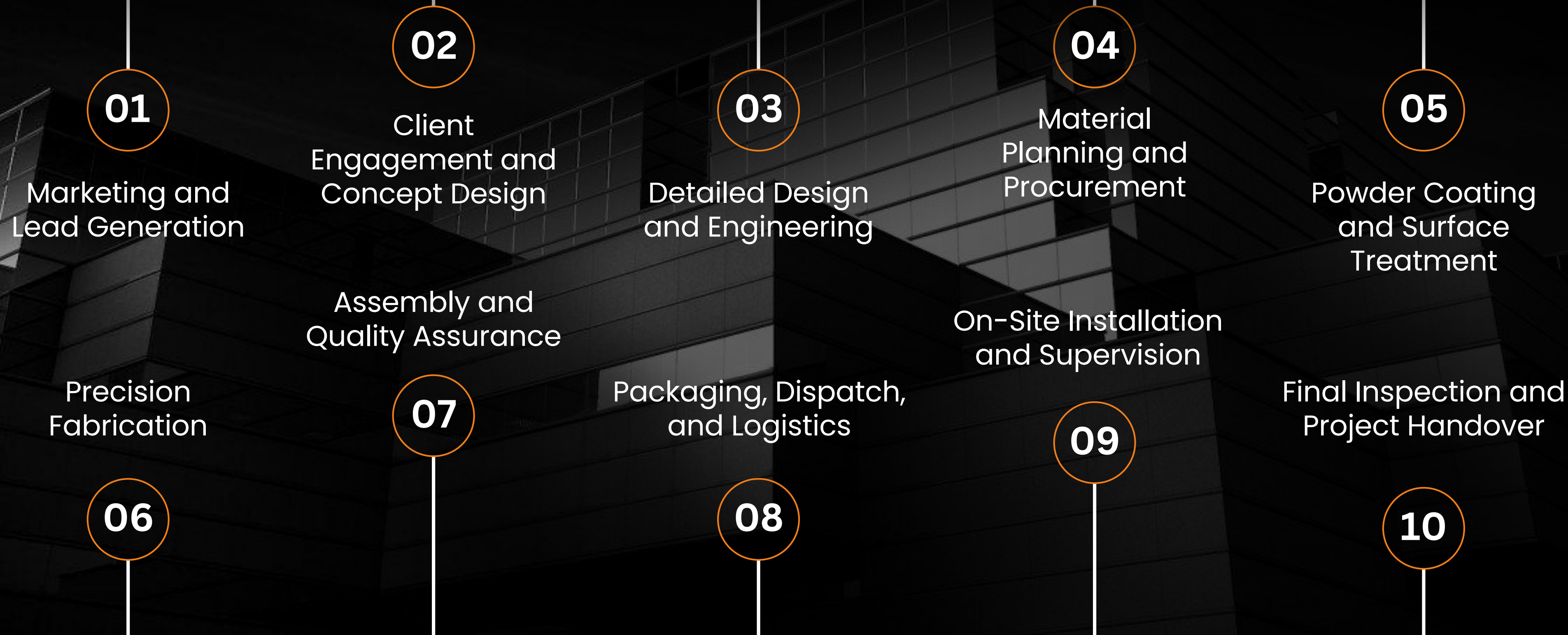

Business Strategy

Enhancing Operational Efficiency

Boosting efficiency through advanced automation, in-house powder coating, CNC processing, and continuous process and technology upgrades to improve cost, speed, and competitiveness.

Capacity Expansion with New Facility

Setting up a new manufacturing unit at Rajoda, Bavla to increase production capacity, reduce turnaround time, improve margins, and support a broader product portfolio.

Geographic & Regional Expansion

Expanding into new cities and states with showrooms, experience centres, and regional offices to strengthen customer engagement, brand visibility, and sales growth.

Commitment to Quality Excellence

Ensuring superior product standards through ISO 9001:2015 and MSME ZED Bronze certifications, supported by rigorous quality controls across all stages.

Strengthening Industry Relationships

Deepening partnerships with developers, architects, and corporates by offering customised façade solutions, technical support, and reliable project execution.



Marketing Strategies

Two-pronged marketing strategy focused on customer retention and new client acquisition.

Strong repeat business driven by personalized post-sales communication, brand recall, and selective incentives.

New client acquisition through direct outreach, referrals, and promoter networks, highlighting technical expertise and robust project management.

Expanding visibility via trade shows, industry events, dedicated showrooms, and a first-of-its-kind experience centre.

Strengthening network presence on platforms such as GIHED, CREDAI, and BNI.

Projections

PROJECTED PROFIT AND LOSS ACCOUNT				
	(Rs. In Lakhs)			
	Audited	Estimated	Estimated	Estimated
Particulars	FY 2024-25	FY 2025-26	FY 2026-27	FY 2027-28
Revenue from Operations	4,210.85	7,000.00	10,500.00	15,100.00
Other Income	3.61	6.00	15.00	17.50
Total Income	4,214.45	7,006.00	10,515.00	15,117.50
Cost of Materials Consumed	1,955.01	3,150.00	4,725.00	6,795.00
Labour Charges	488.75	840.00	1,260.00	1,812.00
Changes in inventories	-516.13	-	-	-
Employee Benefits Expense	380.50	490.00	735.00	1,057.00
Other Operating Expenses	832.24	898.82	970.72	1,048.38
EBITDA	1,074.08	1,627.18	2,824.28	4,405.12
Depreciation	135.08	120.00	250.00	225.00
Finance Cost	251.35	200.00	315.00	453.00
Profit Before Tax (PBT)	687.65	1,307.18	2,259.28	3,727.12
Tax Expense	173.01	326.80	564.82	931.78
Profit After Tax (PAT)	514.64	980.39	1,694.46	2,795.34
KEY ASSUMPTIONS				
	-	-	-	-
Assumptions	FY 2024-25	FY 2025-26	FY 2026-27	FY 2027-28
Capacity Utilisation (%)	50%	70%	95%	95%
Sales Growth (%)	58%	66%	50%	44%
Raw Material Cost (%)	34%	45%	45%	45%
Labour Cost (%)	12%	12%	12%	12%
Employee Cost (%)	9%	7%	7%	7%
Finance Cost (%)	6%	3%	3%	3%
MARGIN ANALYSIS				
	-	-	-	-
Particulars	FY 2024-25	FY 2025-26	FY 2026-27	FY 2027-28
EBITDA Margin (%)	26%	23%	27%	29%
PAT Margin (%)	12%	14%	16%	19%

A low-angle, black and white photograph of a modern building. The building features a prominent spiral staircase on the right side, which is brightly lit, creating a strong contrast with the dark, shadowed facade of the building. The building's facade is composed of many rectangular windows, some of which are illuminated from within. The overall composition is dynamic, with strong geometric lines and a sense of height and scale.

Management Overview



Profile Of Our Directors



Rupesh Pravinhbhai Shah

Promoter & Managing Director

Aged 51 years, is the Promoter and Managing Director of our Company. He has pursued undergraduate studies in Commerce at Gujarat University. He is responsible for overseeing our Company's diverse operations, which include the manufacturing, processing, procurement, and distribution of a wide range of aluminium sections, windows, doors, partitions, furniture, architectural hardware, related materials used in commercial, domestic, and industrial projects. He brings with him an overall experience of over 35 years in the manufacturing sector and has been instrumental in leading and supervising projects. He has been associated with our Company as an Executive Director since March 30, 2012, and has been serving as the Managing Director since May 01, 2025.



Hrishikesh Rupesh Shah

Promoter & Executive Director

Aged 22, is the Promoter and Executive Director of our Company. He has cleared higher secondary education in commerce from the Central Board of Secondary Education (CBSE), laying the academic foundation for his role in business leadership and strategic oversight. He is entrusted with driving technological integration, overseeing regulatory and legal matters relating to compliance and initiatives related to expansion planning and market penetration. He also plays an integral role in the management of safety and compliance frameworks within the organization. He has been associated with our Company since July 11, 2024.

Key Management Personnel



Shail Jayesh Shah

Non-Executive Independent Director

A Chartered Accountant with 13+ years of experience in finance, compliance, and risk management. Serves as CFO of GSP Crop Science Ltd. and brings strong financial strategy expertise. On our Board since May 01, 2025.



Heta Hiren Shah

Non-Executive Independent Director

Engineering professional with 5+ years of industry experience across analytics and business strategy. Currently Head of Sports Vertical at Vedanta Limited. On our Board since May 01, 2025.



Niki Nitin Thakkar

Non-Executive Independent Director

Commerce graduate and MBA in Finance; qualified Advocate and Company Secretary (Executive). Proprietor of N. Thakkar & Associates, specializing in corporate and regulatory legal matters. Joined the Board on May 01, 2025.



Oswal Samirkumar Kantilal

Chief Financial Officer (CFO)

A seasoned finance professional with 15 years of experience in accounting, financial operations, and strategic financial management. He leads financial planning, performance monitoring, stakeholder communication, and team leadership. Previously worked with Japan International and Macro Polymers Pvt. Ltd..



Siddhi Mangal

Company Secretary & Compliance Officer

Brings over 2 years of experience in corporate secretarial and compliance functions. Joined the Company on March 03, 2025. She ensures strong governance practices, manages statutory compliance, and supports the Board on legal and regulatory matters. Earlier associated with S.S. Thakkar & Co. and Mevada & Co.

Senior Management Personnel



Ashish Ram Jadhav

President – Facades

Brings decades of experience across manufacturing, fabrication, and project management. Started his career at Godrej & Boyce as Production Officer, followed by 14 years at SP Fabricators Ltd. as Project Manager, where he led end-to-end project execution, resource planning, and on-site coordination for major fabrication and infrastructure assignments.



Arun Singh

General Manager – Facades

Oversees execution and management of façade projects, bringing extensive experience in façade systems, project leadership, and strategic execution. Joined on November 15, 2024. Formerly Vice President – Projects at HIFAB Aluminium Pvt. Ltd. and Partner at International Glazing Systems and Technologies, where he led operations, project planning, and client engagements.



Shah Satyam Shaileshkumar

Head of Production

A seasoned professional with 6+ years of experience in manufacturing operations, process optimisation, and information systems. Leads complete production operations for aluminium glazing and façade systems, driving capacity expansion, quality control, and continuous improvement.

THANK YOU



HRS Aluglaze Limited

601, W1, Off S.G. Highway, Ambli
Road, Ahmedabad, Gujarat

Phone: +91-079-26306595

Email: info@hrsaluglaze.com

Website: www.hrsaluglaze.com